

## 146-K-62 - SPEEDLINE System Data Sheet - Version V1 (24-10-23)

SPEEDLINE 146mm 'C' Stud Partition @600mm  
Ctrs, with 2x Knauf 15mm Fire Panel each side,

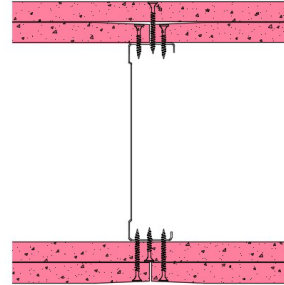

### System Performance Breakdown

Fire Resistance:

BS476 Part 22:1987:

Test Ref & Date or Applied Ref & Report:

Max Height:

Thickness:

Duty Grade: BS 5234: Part 2:1992:

Sound Insulation:

**120/120 Minutes (Integrity/Insulation).**

**BRE 288793 - BRE Report P102396-1011B**

**Refer to Speedline Specification Clause**

**208 mm.** (At Base Track, Excluding Finishes)

**Severe - Annexes A-F**

**46  $R_w$ dB**, Date Tested or Assessed Against - 70-K-57

Test Code:  
**H17517AA**  
Test Date:  
08/08/2011

Freq. Hz	R dB
50	20.8
63	15.3
80	10.7
100	19.6
125	22.5
160	31.4
200	35.4
250	36.9
315	39.1
400	43.1
500	47.7
630	49.4
800	54.1
1 000	55.5
1 250	57.5
1 600	60.6
2 000	60.7
2 500	51.0
3 150	46.6
4 000	49.4
5 000	53.1
6 300	
8 000	
10 000	

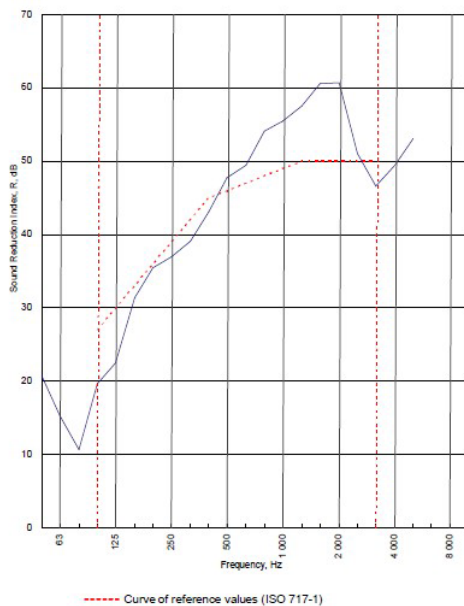



Rating according to BS EN ISO 717-1:1997	<b><math>R_w</math> (C;Ctr) = 46 (-3;-9) dB</b>		
Evaluation based on laboratory measurement results obtained by an engineering method:	$C_{50-150} = -6$ dB	$C_{50-500} = -5$ dB	$C_{100-500} = -2$ dB
	$C_{1,50-3150} = -16$ dB	$C_{1,50-4000} = -16$ dB	$C_{1,100-5000} = -9$ dB

TESTED AT ONE OF THE UKAS ACCREDITED LABORATORIES BELOW

B.T.C (H-Ref on Graph) 

B.R.E 

AIRO 

S.R.L 

Customer: Metsec plc Hepsec Division

BTC 17517A: Page 8 of 10



SPEEDLINE Drywall Systems, Adsetts House, 16 Europa View, Sheffield Business Park, Sheffield, S9 1XH.

Tel: 0114 231 8030.

Email: [enquiries@speedlinedrywall.co.uk](mailto:enquiries@speedlinedrywall.co.uk)

(As per the requirements set out in ISO/IEC 17025:2017 regarding test data the results stated have been carried out by voestalpine Metsec plc as part of the contract to supply Speedline Metal Sections to SIG Plc)